



Instructions for Use

Crescent Barrier Extensions

Under the Wafer

1. Clean the skin with water and dry, avoid using soap.
2. Remove paper from the crescent barrier extension.
3. Smooth the crescent barrier extension around the stoma. Your natural body temperature will help secure the seal.
4. Secure ostomy wafer over crescent barrier extension.
5. *Optional!* For additional security, place directly around the edges of the wafer. Form a "picture frame" around the border of the wafer, using 1-3 extensions.

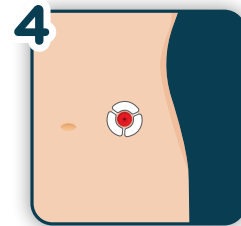
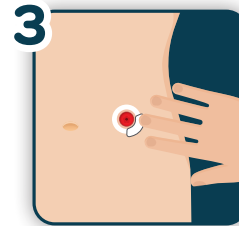



Instructions for Use Crescent Barrier Extensions

Over the Wafer

1. Clean the skin with water and dry, avoid using soap.
2. Secure ostomy wafer to skin.
3. Remove paper from the crescent barrier extension and place directly around the edges of the wafer. Form a "picture frame" around the border of the wafer, using 1-3 extensions.
4. Smooth the crescent barrier extension around the wafer with your finger. Your natural body temperature will help secure the seal.

